

THE CORPORATE COMMON SEAL
 of THE BOROUGH COUNCIL of CALDERDALE
 was hereunto affixed on the day of September
 2020 9th
 in the presence of :- *M Marshall*
 Authorised officer

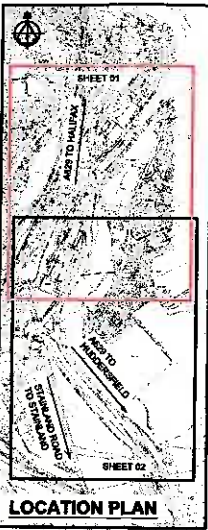

LIMIT OF SCHEME

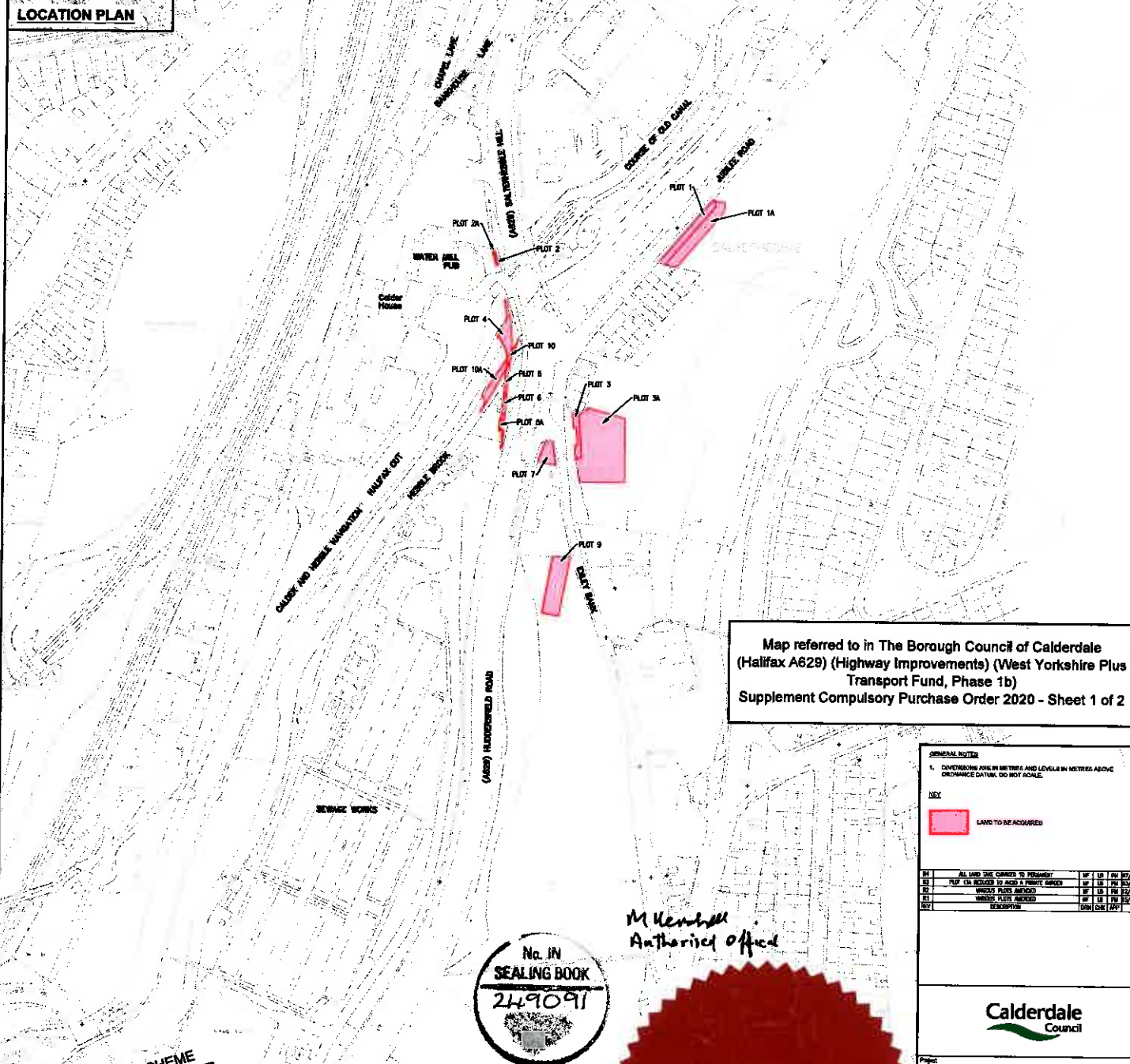

Map referred to in The Borough Council of Calderdale
 (Halifax A629) (Highway Improvements) (West Yorkshire Plus
 Transport Fund, Phase 1b)
 Supplement Compulsory Purchase Order 2020 - Sheet 1 of 2

GENERAL NOTE

1. COORDINATES ARE IN METRES AND LEVELS IN METRES ABOVE ORDNANCE DATUM. DO NOT SCALE.

KEY

LAND TO BE ACQUIRED

DR	ALL LAND SHOWN ON THIS PLAN	DR	17/09/20	DR	17/09/20
ES	PLANS TO BE ACQUIRED	ES	17/09/20	ES	17/09/20
IS	PLANS TO BE ACQUIRED	IS	17/09/20	IS	17/09/20
CS	PLANS TO BE ACQUIRED	CS	17/09/20	CS	17/09/20
RS	PLANS TO BE ACQUIRED	RS	17/09/20	RS	17/09/20



M Marshall
 Authorised officer



LIMIT OF SCHEME

CUTLINE SEE SHEET 2

Calderdale Council

Project: A629 CORRIDOR PHASE 1B

Drawing Title: LAND ACQUISITION REQUIREMENT SUPPLEMENTARY CPO (ALL PLOTS) SHEET 1 OF 2

Drawn	MF	17/09/20	1:1000 (A4)
Checked	LI	17/09/20	File No. DW50936 LAND CPO-120 to 121.dwg
Approved	MW	17/09/20	Drawing Status: FINAL

Drawing No: DW50936 LANDCPO/120

Scale: R4

Reproduced by permission of Ordnance Survey on behalf of HM Coastguard. © Crown copyright and database right 2011. All rights reserved. Ordnance Survey Licence number: 100016225